

Choose the machine torch consumables

Powermax systems with the Duramax 180° full-length machine torch or Duramax 180° mini machine torch are shipped with a box of consumables. In addition, an ohmic-sensing retaining cap is available for use with shielded consumables.

With shielded consumables, the torch tip may touch the metal when cutting. With unshielded consumables, you must keep the torch a small distance, about 2-3 mm (.08-.12 inch), away from the metal. Unshielded consumables generally have a shorter life than shielded consumables. Depending upon which system you order, you may receive a starter consumable kit with a standard retaining cap or ohmic retaining cap.

Both styles of machine torches use the same consumables.

Machine torch consumables

Mechanized shielded 105 A consumables

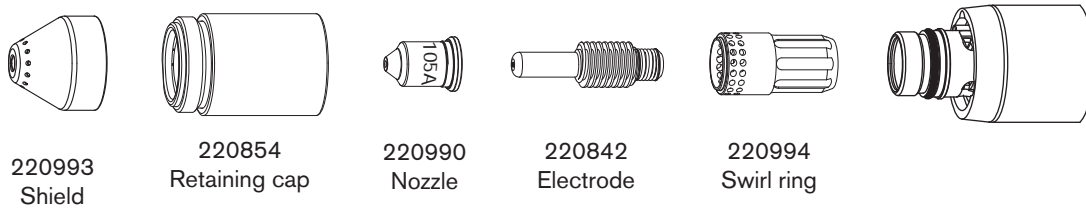

Mechanized shielded 45 A, 65 A, 85 A consumables

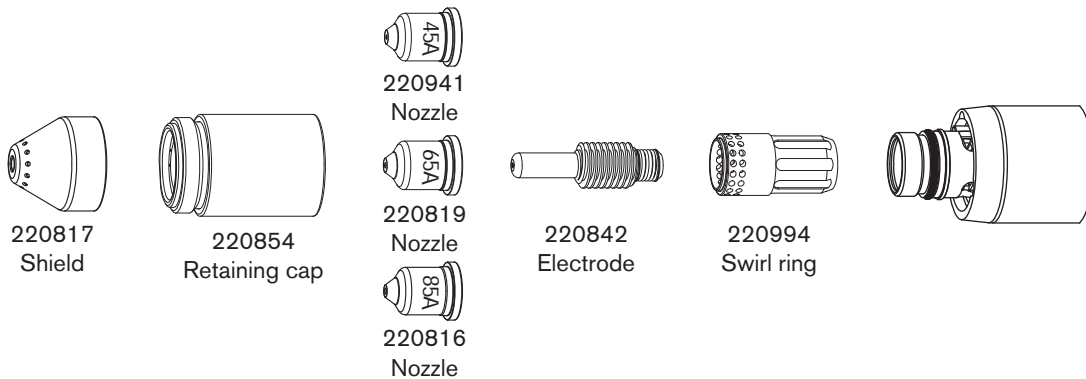

MACHINE TORCH SETUP

Mechanized shielded with ohmic 105 A consumables

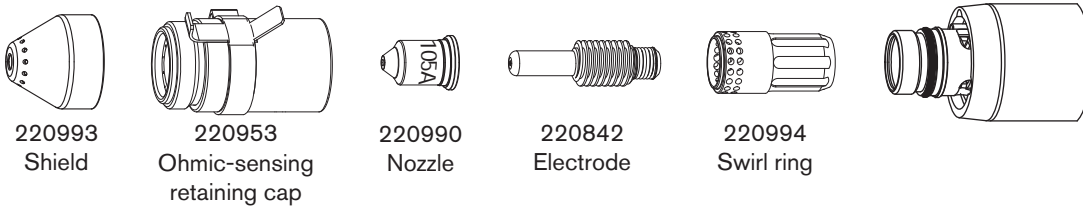

Mechanized shielded with ohmic 45 A, 65 A, 85 A consumables

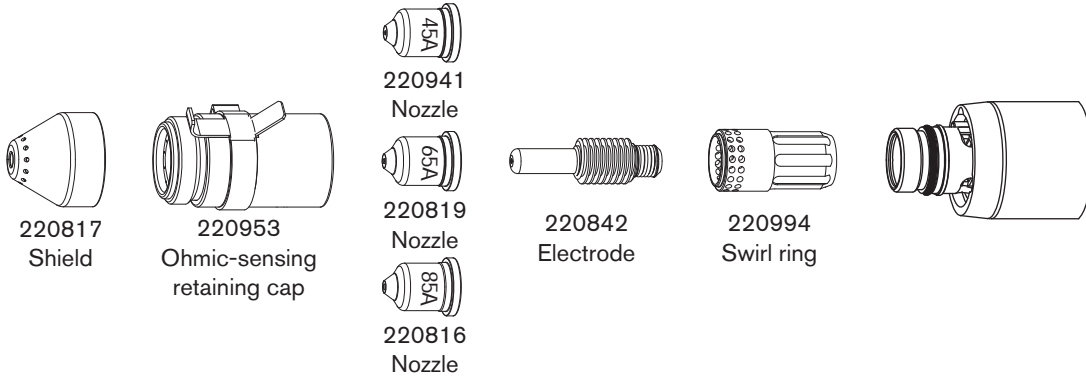

Mechanized unshielded 105 A consumables

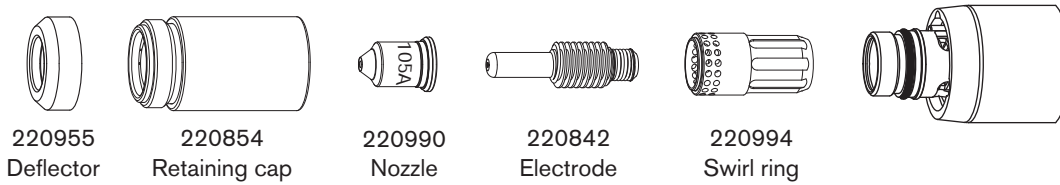

Mechanized unshielded 45 A, 65 A, 85 A consumables

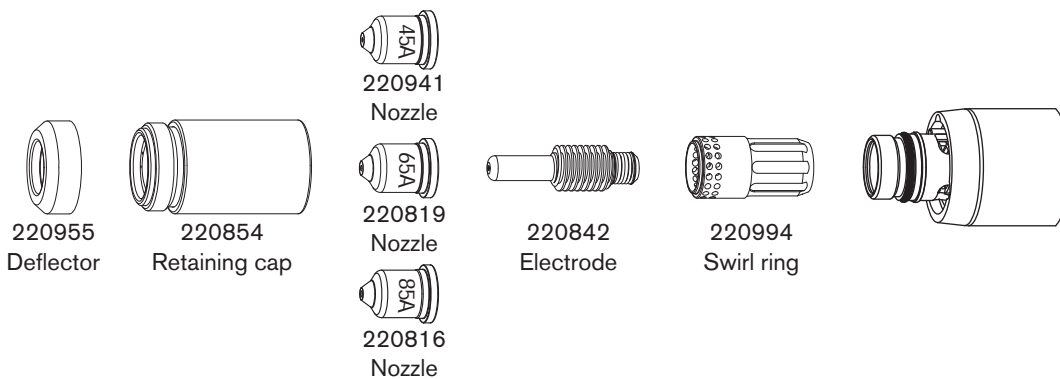

Gouging consumables

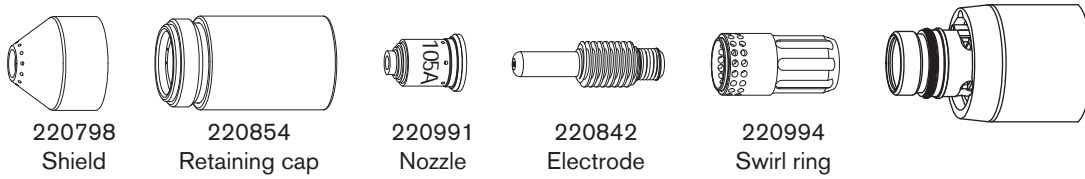

FineCut® shielded consumables

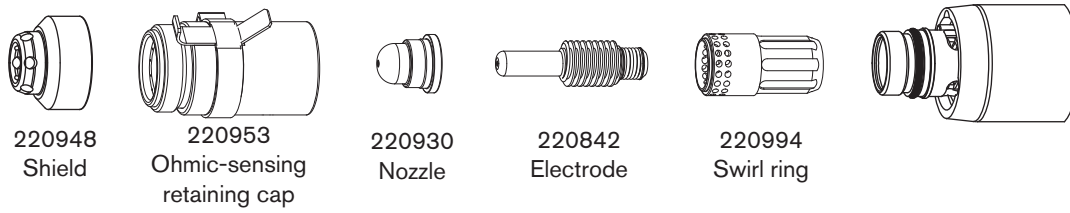

FineCut® unshielded consumables

